

Mi Vacuum Cleaner G10 User Manual



Safety Instructions

This product is for household use only. Read this manual carefully before use, and retain it for future reference.

This appliance can be used by children aged from 8 years and above and persons with reduced physical, sensory or mental capabilities or lack of experience and knowledge if they have been given supervision or instruction concerning use of the appliance in a safe way and understand the hazards involved. Children shall not play with the appliance. Cleaning and user maintenance shall not be made by children without supervision.

The vacuum cleaner is not a toy. Children may not play with or operate this product. Please exercise caution when using the vacuum cleaner near children. Do not allow children to clean or maintain the vacuum cleaner unless supervised by a parent or guardian.

Only use the vacuum cleaner on dry indoor surfaces. Do not install, charge, or use this product outdoors, such as in bathrooms, or near a pool.

Do not touch the plug or any part of the vacuum cleaner with wet hands.

To reduce the risk of fire, explosion, or personal injury, check to make sure the lithium-ion battery and charger are undamaged before use. Do not use the vacuum cleaner if either the battery or charger is damaged.

The smart high torque brush bar, mini electric brush, battery, extension rod, and the vacuum cleaner are electrically conductive and should not be immersed in water or other liquid. Make sure all parts are thoroughly dry after you carry out cleaning on them.

To prevent injury caused by moving parts, turn off the vacuum cleaner before cleaning the smart high torque brush bar and mini electric brush. The smart high torque brush bar, dust compartment, and filter must all be properly installed before using the vacuum cleaner.

Safety Instructions

Only use the BLJ24W308080P-V battery charger provided with the appliance.

Only use the P2046-7S1P-BC battery pack provided with the appliance.

If the charger or battery becomes damaged, it must be replaced with a genuine component purchased from the manufacturer or after-sales service department.

Do not use the vacuum cleaner to pick up flammable or combustible liquids, such as gasoline, bleach, ammonia, or drain cleaners; nor other liquids like water.

Do not use the vacuum cleaner to pick up drywall particles, ashes like fireplace ash, or smoking or burning materials such as coal, cigarette butts or matches.

Do not use the vacuum cleaner to pick up sharp or hard objects, such as glass, nails, screws, or coins, which may damage the product.

Keep hair, loose clothing, fingers, and other parts of the body away from the vacuum cleaner's openings and moving parts. Do not point the suction opening, extension rod, or other accessories at your eyes or ears or put them in your mouth.

Do not put any object into the vacuum cleaner's openings, nor use the vacuum cleaner with any opening blocked. Keep free of dust, lint, hair, or other items which may reduce airflow.

Do not rest the vacuum cleaner against a chair, table, or other unstable surfaces, as this may cause damage to the product or personal injury. If the vacuum cleaner malfunctions because of being knocked over or damaged, please contact the authorized service department. Never attempt to disassemble the vacuum cleaner on your own.

Only use the original charger to charge the product in environments with an ambient temperature of 0°C to 40°C. Otherwise, the battery may damage.

The dust compartment cover, pre-filter, cyclone assembly, and HEPA filter must all be properly installed prior to using the vacuum cleaner.

Make sure the vacuum cleaner is unplugged when not used for extended periods as well as prior to performing any maintenance or repairs.

Please be extra careful when using the vacuum cleaner to clean stairs.

Fire Hazard Warning: Do not apply any type of fragrance to the vacuum cleaner's filter. These types of products are known to contain flammable chemicals which may cause the vacuum cleaner to catch fire.

When Battery is not in use, keep it away from all metal objects, such as paper clips, coins, keys, nails, or screws. Shorting the battery terminals together increases the risk of fire or burns.

Under abusive conditions, liquid may be ejected from the battery. Avoid contact with liquid, as it may cause irritation or burns. If contact occurs, flush with water. If liquid contacts eyes, seek medical help.

DO NOT expose the battery and appliance to fire as it may cause explosion.

DO NOT expose or submerge the battery and appliance in any water, salt water, or other liquids.

Please strictly follow the instructions in this user manual when using the vacuum cleaner. Users are responsible for any loss or damage that may arise from improper use of the vacuum cleaner.

We Dreame Technology (Tianjin) Limited, hereby, declare that this equipment is in compliance with the applicable Directives and European Norms, and amendments. The full text of the EU declaration of conformity is available at the following internet address:

<http://www.mi.com/global/service/support/declaration.html>

Product Overview

Accessories List

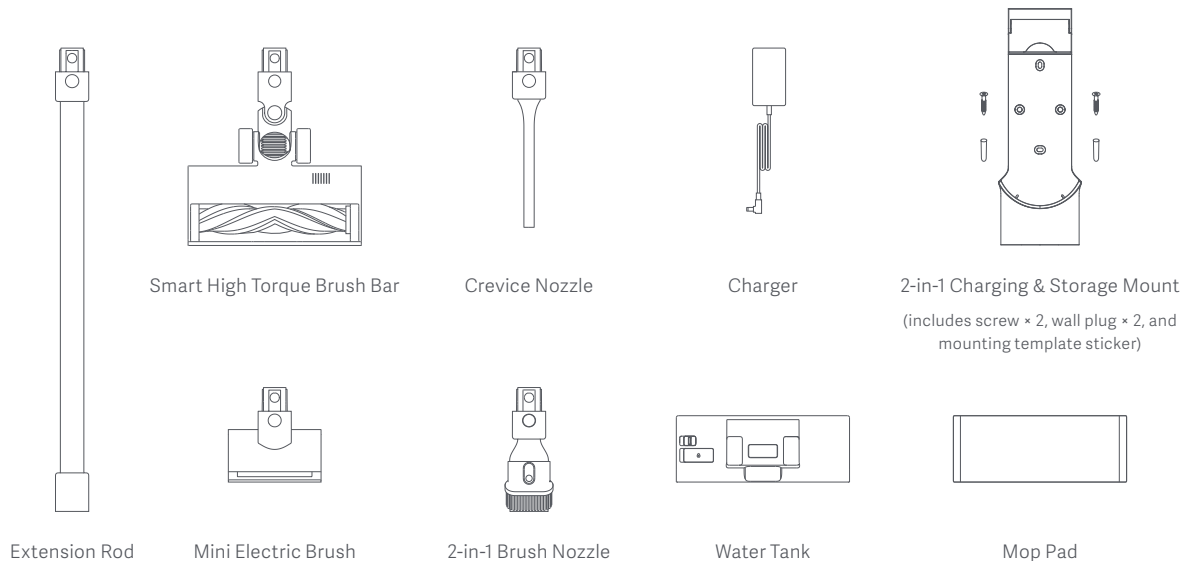

Note: Illustrations of product, accessories, and user interface in the user manual are for reference purposes only. Actual product and functions may vary due to product enhancements.

Product Overview

Component Name

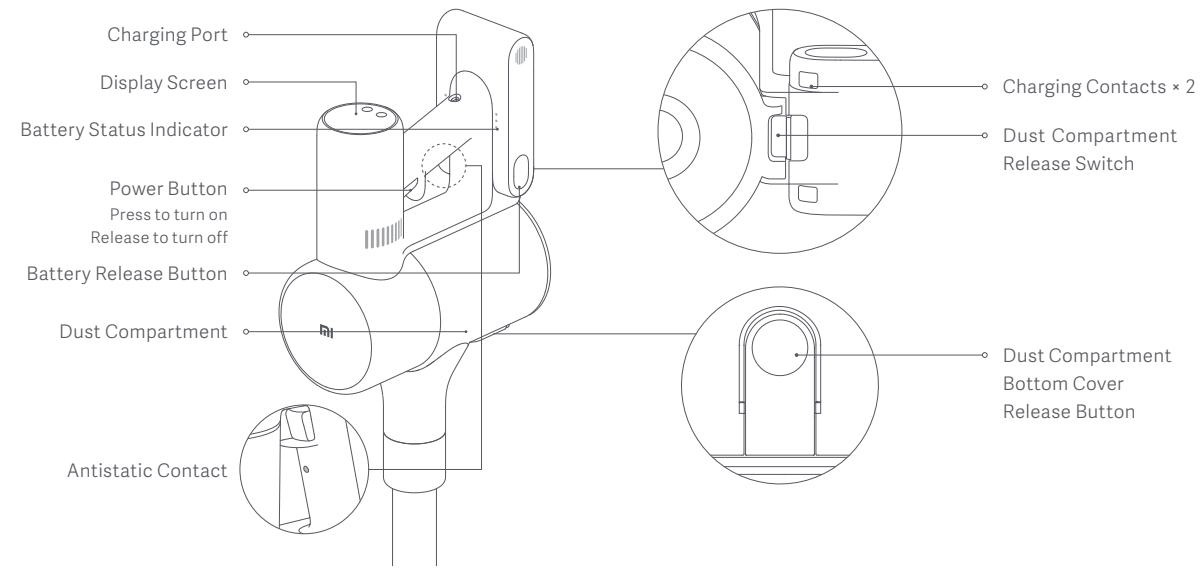

Product Overview

Display Screen

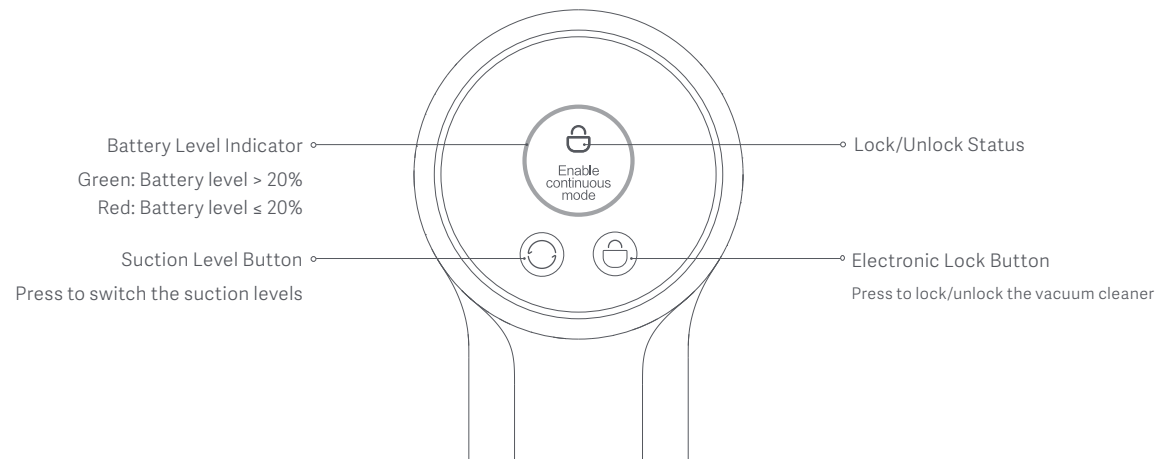

Note: If the vacuum cleaner experiences a malfunction, the display screen will show an error message. For a solution, please refer to the Troubleshooting section.

How to Install

Installing the Accessories onto the Vacuum Cleaner

 Insert until it clicks into place

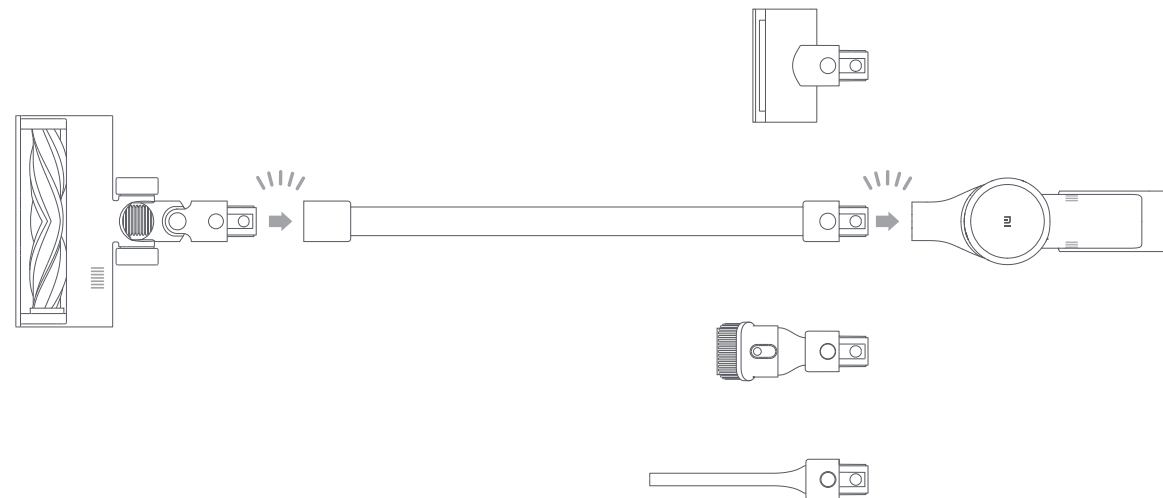

Note: Mini electric brush should not be used with the extension rod.

How to Install

Installing the 2-in-1 Charging & Storage Mount

1. The 2-in-1 charging & storage mount should be installed in a cool, dry place with an electrical outlet nearby. Prior to installing, ensure that there are not any wires or pipes in the space directly behind where the mount will be installed.
2. The bottom of the mounting template sticker should be level and at least 1.03 m from the ground, and its top should have at least 30 cm of clearance above it.

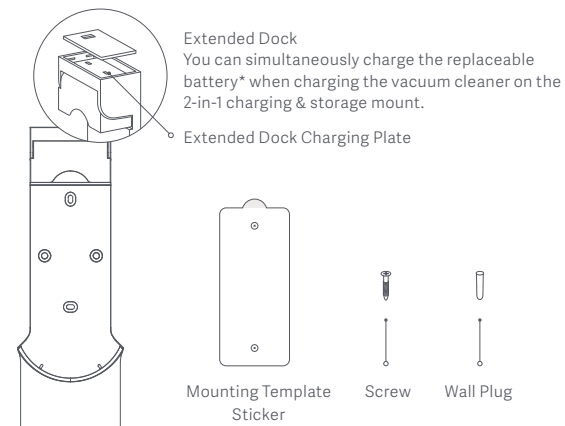

3. Use a power drill with an 8 mm drill bit to drill a hole into each hole marker on the mounting template sticker, then insert a wall plug into each hole.
4. Align the mounting holes on the 2-in-1 charging & storage mount to the holes on the wall, then attach the mount to the wall using the included screws.

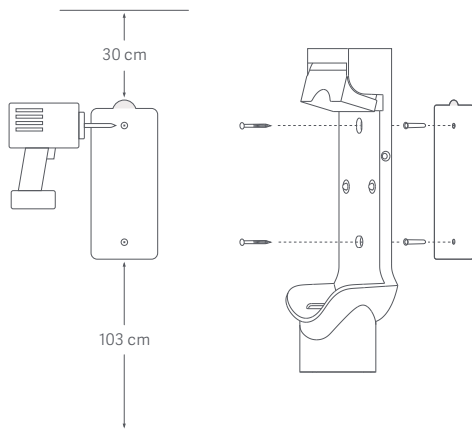

Recommended Height: At least 1.03 meters from the ground

Charging

Battery Status Indicator

- Off ☀️ Blinking ● On
- ☀️ ○ ○ Low battery
- ☀️ ○ Half battery
- ● ☀️ Nearly full
- ● ● Fully charged

Once the vacuum cleaner is fully charged, the indicator will turn off after 5 minutes, and the vacuum cleaner will then enter the energy-saving mode.

Display Screen

The number on the display screen represents the current battery level in a percentage during charging. When the number turns into 100, the battery is fully charged.

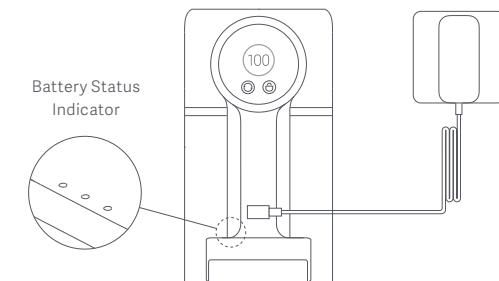

Charging the vacuum cleaner with the charger

Notes:

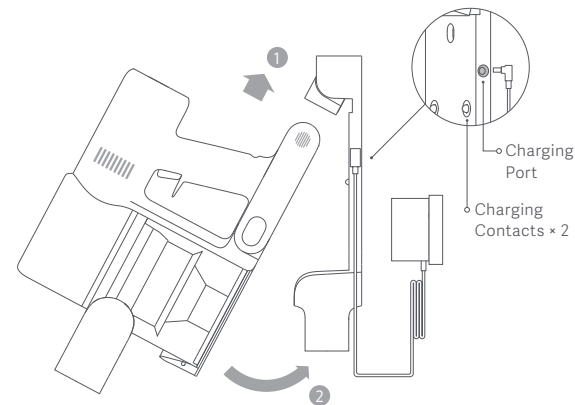

- Fully charge the vacuum cleaner before using it for the first time. This will take about 4 hours.
- The vacuum cleaner cannot be used while charging.
- Vacuuming at the highest suction level for a prolonged period will cause the battery to heat up, which may increase the charging time. Before charging the vacuum cleaner, it is better to cool it down for 30 minutes.



Charging the vacuum cleaner on the charging mount

How to Use

Setting Language

Press and hold the button  for 3 seconds to open the language list, then press the button  to scroll through the language to select the desired one. Press and hold the button  for 2 seconds to use the selected language.

Note: The display screen will go off if there is no operation for more than 10 seconds.

Switching Suction Levels

Press the button  to switch suction levels of eco, standard/ auto, and high power. The corresponding suction level will be highlighted on the display screen.

Only when using the smart high torque brush bar, the auto mode will be activated and the notification of "Auto" will appear on the display screen. The vacuum cleaner will then automatically switch the suction level between the floor/tile and the carpet.

Note: Stop the vacuum cleaner at any time while cleaning, it will continue to use the last selected suction level when started again.

Working Modes

The vacuum cleaner has two working modes, you can select the desired one based on your cleaning needs.

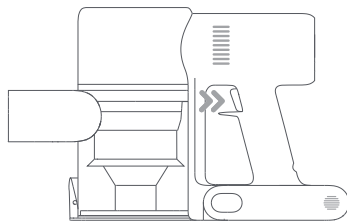

1. Non-continuous Mode

Hold down the power button to start the vacuum cleaner, then release to stop it.



Non-continuous Mode

2. Continuous Mode

Press the button  to enable Continuous Mode, then press the power button to turn the vacuum cleaner on. To exit Continuous Mode, press the button .

Enabling the Continuous Mode allows the vacuum cleaner to run continuously without having to hold down the power button, which can help release your fingers.

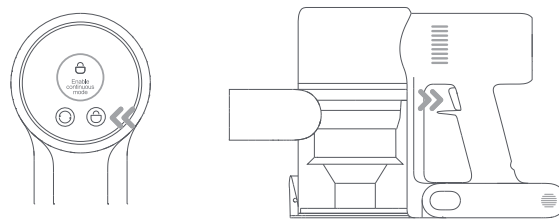

Continuous Mode

Notes:

- In Continuous Mode, the vacuum cleaner will enter into standby mode when pressing the power button, and resume running if pressing the button again.
- When the vacuum cleaner keeps in standby mode for more than 10 seconds, its display screen will go off and the vacuum cleaner will then exit the Continuous Mode.

Using Different Accessories

2-in-1 Brush Nozzle: For vacuuming curtains, sofas, vehicle interiors, coffee tables, etc.

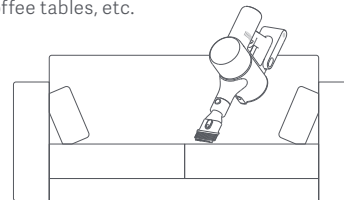

Mini Electric Brush: For vacuuming dirt, pet hair, and other stubborn debris from sofas, bedding, and other fabric surfaces.

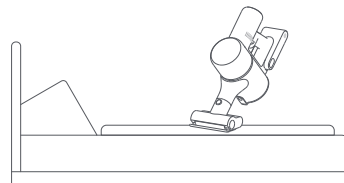

Notes:

- If any rotating part becomes stuck, the vacuum cleaner may shut off automatically. Remove any trapped foreign objects, then resume use.
- When the motor runs overheated, the vacuum cleaner will automatically shut off. Wait until the battery temperature returns to normal, then resume use.

How to Use

Using Different Accessories

Crevice Nozzle: For vacuuming narrow crevices and areas around doors, windows, baseboards, corners, stairs, etc.

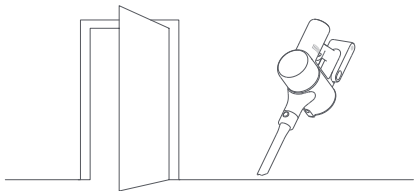

Smart High Torque Brush Bar: For cleaning different types of flooring such as wood, marble, tile, and short carpet. When Auto Mode is activated, the vacuum cleaner can automatically adjust its suction level depending on the surface type.

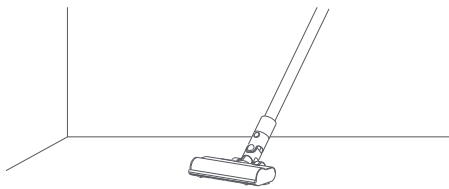

Note: The smart high torque brush bar can be attached directly to the vacuum cleaner.

Using the Mopping Function

Notes:

- Do not step on the water tank, as this could permanently damage it.
- Heavily soiled floors should be vacuumed prior to mopping for a better result.
- Do not use the mopping function on carpet.
- Do not use any cleaning agents or disinfectants.

1. Dampen the mop pad and wring out excess water, then attach it securely to the bottom of the water tank.

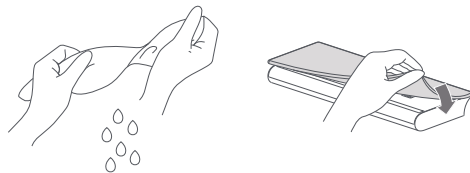

2. Open the water tank plug, add an appropriate amount of clean water, then close the plug.

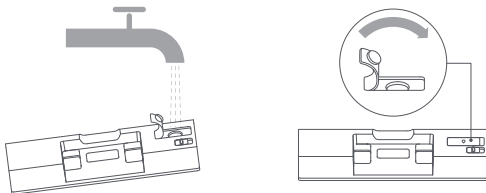

How to Use

3. Attach the smart high torque brush bar to the water tank by lining up the magnets on each component until they snap together.

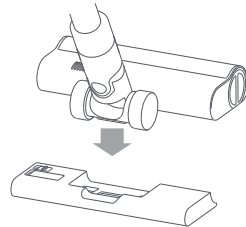

4. This function is designed for vacuuming and wiping down hardwood and tile floors.

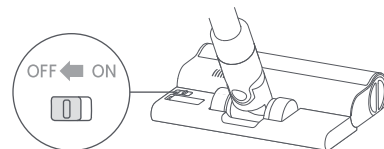

Notes:

- The ball valve in the water tank controls how much water is dispensed. The ball is a moving part and may make a rolling sound when starting and stopping. This is normal.
- When not in use, please keep the switch to the OFF position.

Care & Maintenance

Maintenance Precautions

- Always use genuine parts to keep your warranty from being voided.
- If the filter, extension rod, or smart torque brush bar becomes clogged, the vacuum cleaner will stop working shortly. To restore its functionality, clean the clogged component.
- If the vacuum cleaner will not be used for an extended period, fully charge it and disconnect it from the power then store it in a cool, low-humidity environment away from direct sunlight. To avoid over-discharging the battery, recharge the vacuum cleaner at least once every three months.

Cleaning the Vacuum Cleaner

Wipe the vacuum cleaner with a soft, dry cloth.

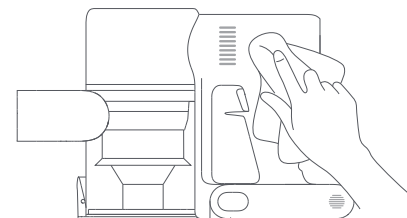

Care & Maintenance

Cleaning the Dust Compartment, Pre-filter, and Cyclone Assembly

1. The vacuum cleaner's cleaning ability will be reduced if the dust compartment is filled to the "MAX" mark. To regain performance, empty the dust compartment in a timely manner. Before emptying the compartment, make sure the vacuum cleaner is disconnected from the power, and do not press its power button.

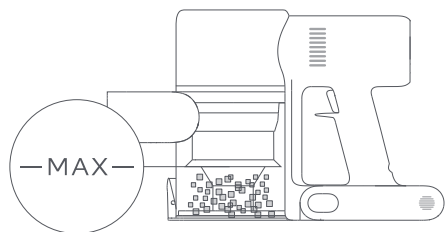

2. Press the dust compartment bottom cover release button, then empty the contents.

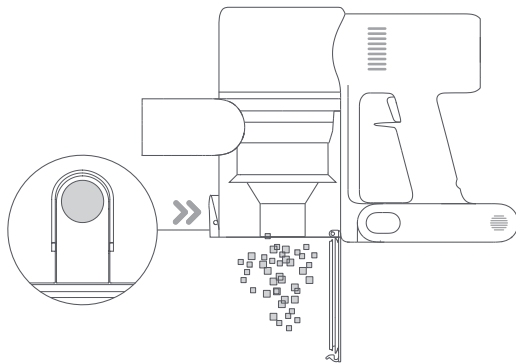

3. Push the dust compartment release switch in the direction indicated by the arrow, then gently remove the dust compartment from the vacuum cleaner.

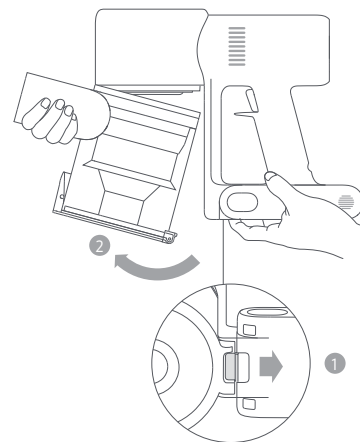

Dust Compartment Release Switch

4. Remove the pre-filter first, then lift the handle of the cyclone assembly and turn to counterclockwise until it stops, then pull to lift out the cyclone assembly.

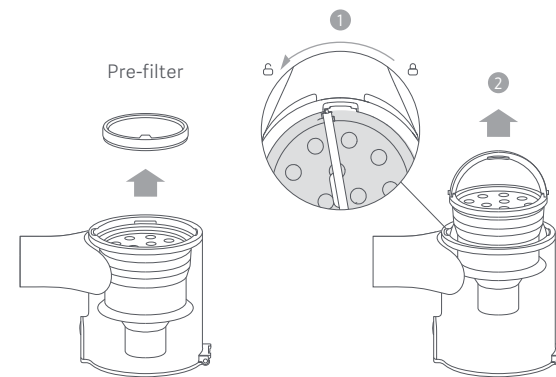

Pre-filter

Care & Maintenance

5. Rinse the pre-filter, cyclone assembly, and dust compartment with water until they are clean, then set each component aside to thoroughly dry for at least 24 hours.

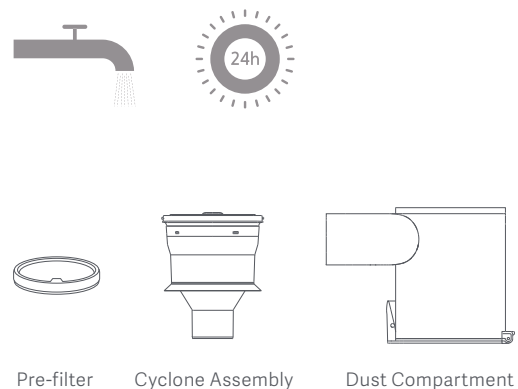

Notes:

- The dust compartment should be rinsed out at least once a month.
- The pre-filter and cyclone assembly should be cleaned once every 3 to 4 months.

Wipe the contact points of the vacuum cleaner with a soft dry cloth if they are dirty.

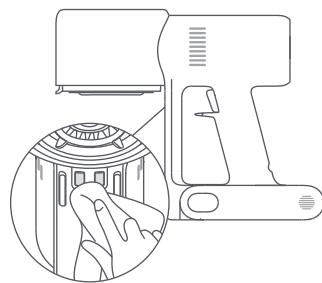

Notes:

- Do not use detergents, polishes, or air fresheners to clean the dust compartment.
- Do not clean the dust compartment, pre-filter, or cyclone assembly in a dishwasher or washing machine, nor attempt to dry any component in a tumble dryer, oven, microwave, or near an open fire.

Installing the Dust Compartment, Pre-filter, and Cyclone Assembly

1. Insert the cyclone assembly vertically into the dust compartment, and make sure that the handle of the cyclone assembly line up with the slot on the left side of the dust compartment. Turn the handle clockwise until it locks, then flip the handle down.
2. Place the pre-filter with its front side facing up into the cyclone assembly.

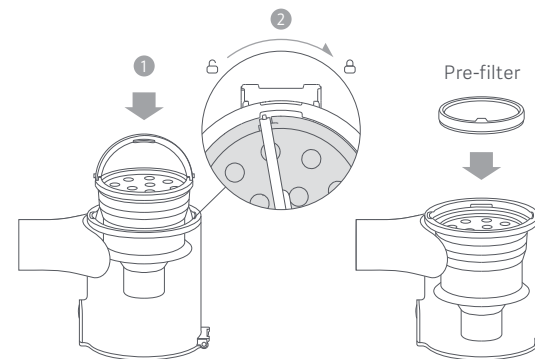

3. Slightly tilt the dust compartment so its slot aligns with the clip on the vacuum cleaner. Then gently push the dust compartment until it clicks into place.

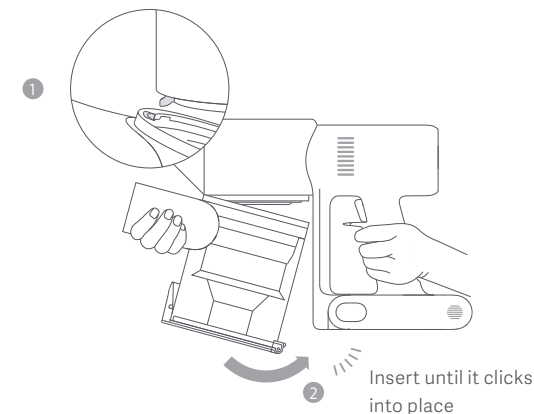

Care & Maintenance

Cleaning the HEPA Filter

Note: It is recommended to clean the HEPA filter once every 4 to 6 months.

1. Remove the dust compartment as shown in the figure.

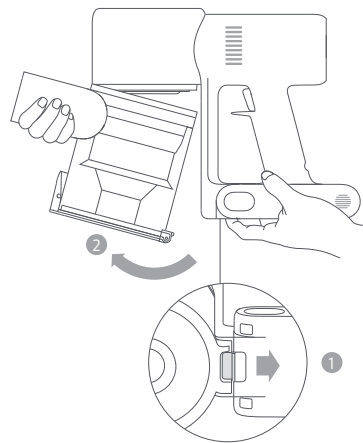

Dust Compartment Release Switch

2. Remove the HEPA filter from the vacuum cleaner by pulling it down in the direction shown in the figure.

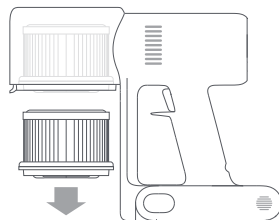

3. Clean the HEPA filter with clean water. Make sure you rotate the HEPA filter 360° to thoroughly remove all dust caught in the filter. Lightly tap the filter several times to remove any excess dirt.

Notes:

- Only use clean water to clean the filter. Do not use detergent.
- Do not attempt to clean the HEPA filter with a brush or finger.

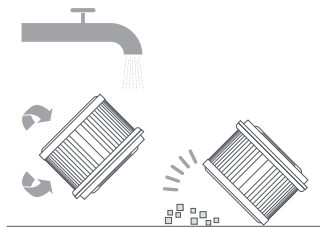

4. Allow the HEPA filter to thoroughly dry for at least 24 hours.



Installing the HEPA Filter

1. Insert the HEPA filter into the vacuum cleaner and gently press down, as illustrated.

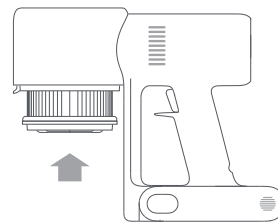

2. Reinstall the dust compartment.

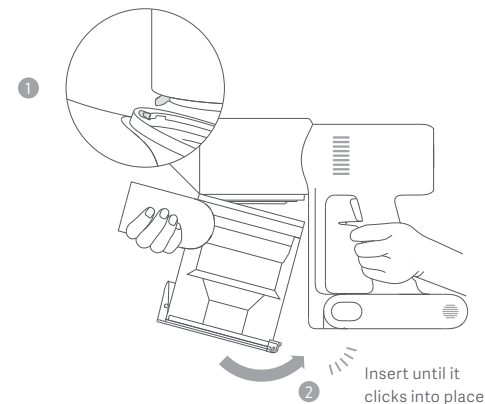

Insert until it clicks into place

Care & Maintenance

Cleaning the Smart High Torque Brush Bar

1. Turn the lock counterclockwise until it stops, then remove the roller brush from the smart high torque brush bar.

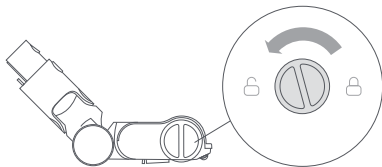

2. Use scissors to cut and pick out any hair or other debris tangled around the roller brush. Wipe away excess dust from the slot and clear plastic cover using a dry cloth or paper towel.

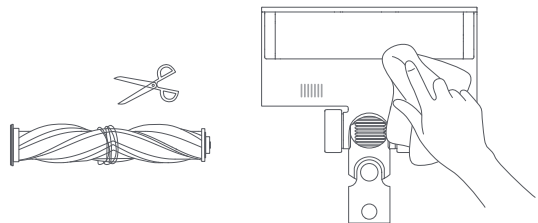

3. After extended use, the roller brush may become dirty and should be washed.

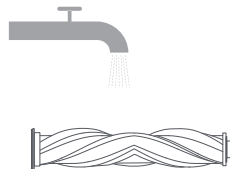

4. After washing, allow the roller brush to dry thoroughly by standing it upright in a well-ventilated area for at least 24 hours.

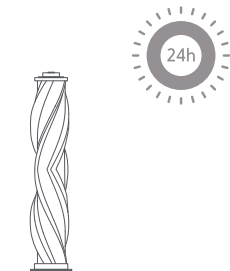

Cleaning the Mini Electric Brush

1. Use a coin to turn the lock counterclockwise until you hear a click.

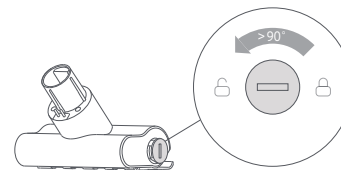

2. After unlocking the roller brush, remove it from the mini electric brush, then rinse and clean the roller brush.

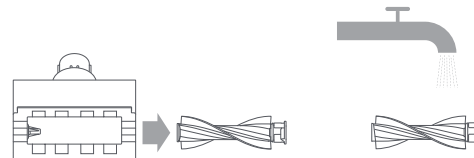

3. After washing, allow the roller brush to dry thoroughly by standing it upright in a well-ventilated area for at least 24 hours.



4. Once the roller brush is dry, reinstall it by following the disassembly steps in reverse.

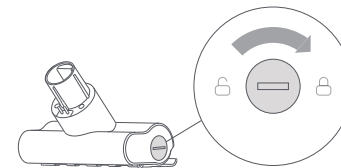

Care & Maintenance

Cleaning the Water Tank and Mop Pad

Notes:

- When the vacuum cleaner is charging or not in use, remove the water tank and drain any remaining water to prevent mildew or lingering odor.
- A worn or damaged mop pad that no longer sticks to the water tank should be replaced to ensure optimal cleaning performance.

1. Slide the water tank down to detach it from the smart high torque brush bar.

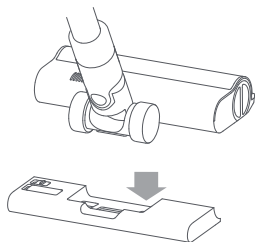

2. Empty the water tank.

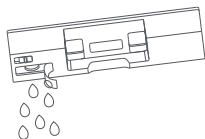

3. Remove the mop pad from the water tank.

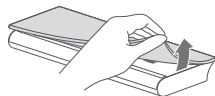

4. Clean and dry the mop pad.

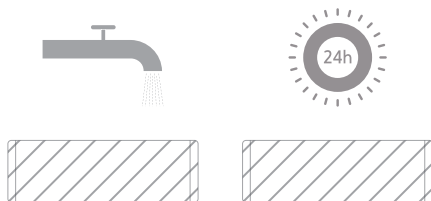

Water Dispenser Filter

The water dispenser filter should be replaced if the water tank dispenses water too slowly or becomes clogged. To ensure optimal mopping effectiveness, it is recommended to replace water dispenser filters once every 3 to 6 months depending on water quality and frequency of use.

1. Use your fingers to slide out old water dispenser filters on the left and right sides of each slot.

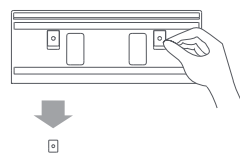

2. Insert the new water dispenser filters and check to ensure they are installed correctly.

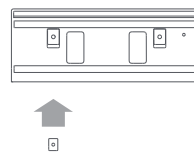

Battery Pack

The vacuum cleaner contains a removable rechargeable lithium-ion battery pack which has a limited number of recharge cycles. After extended use, the battery pack may no longer hold a charge. If this happens, it means the battery pack has reached the end of its life cycle and needs to be replaced.

1. Press down the battery pack release button and slide the battery pack to the right, as illustrated, to remove it.
2. Install the new battery pack.

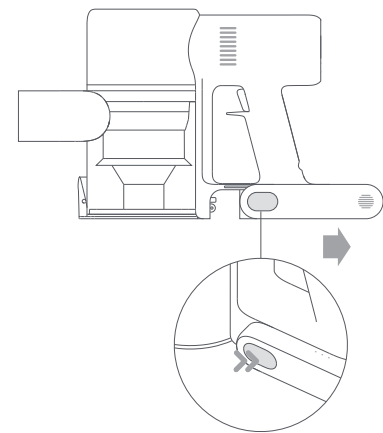

Specifications

Vacuum Cleaner			
Model	MJSCXCQPT	Rated Voltage	25.2 V $\overline{\text{---}}$
Charging Voltage	30.8 V $\overline{\text{---}}$	Nominal Capacity	3000 mAh
Rated Power	450 W	Dust Compartment Capacity	Max. 0.6 L
Charging Time	Approx. 4 hours	Net Weight	4.2 kg
Item Dimensions	1286 × 214 × 256 mm		

Smart High Torque Brush Bar		Mini Electric Brush	
Model	G10-01	Model	1C-02
Rated Power	40 W	Rated Power	20 W
Rated Voltage	25.2 V $\overline{\text{---}}$	Rated Voltage	25.2 V $\overline{\text{---}}$

Specifications

Charger			
Manufactured by	Zhongshan Baolijin Electronic Co., Ltd.	Average Active Efficiency	87.5%
Model	BLJ24W308080P-V	Efficiency at Low Load (10%)	77.9%
Input	100–240 V~ 50/60 Hz 0.8 A	No-load Power Consumption	0.10 W
Output	30.8 V $\overline{\text{---}}$ 0.8 A	24.6 W	

Rechargeable Lithium-ion Battery Pack 71NR19/66			
Battery Model	P2046-7S1P-BC	Nominal Capacity	3000 mAh
Nominal Voltage	25.2 V $\overline{\text{---}}$	Rated Capacity	2800 mAh
Energy	70.56 Wh		

The lithium-ion battery pack contains substances that are hazardous to the environment. Before disposing of the vacuum cleaner, please first remove the battery pack, then discard, or recycle it in accordance with local laws and regulations of the country or region it is used in.

WEEE Information



All products bearing this symbol are waste electrical and electronic equipment (WEEE as in directive 2012/19/EU) which should not be mixed with unsorted household waste. Instead, you should protect human health and the environment by handing over your waste equipment to a designated collection point for the recycling of waste electrical and electronic equipment, appointed by the government or local authorities. Correct disposal and recycling will help prevent potential negative consequences to the environment and human health. Please contact the installer or local authorities for more information about the location as well as terms and conditions of such collection points.







FAQ

Error	Possible Cause	Solution
The vacuum cleaner does not work.	It is out of battery or has low battery.	Fully charge the vacuum cleaner, then resume use.
	It enters into overheat protection mode triggered by a blockage.	Wait until the vacuum cleaner cools down, then reactivate it.
	Its suction opening or airway passage is blocked.	Clear any blockages from suction opening or airway passage.
The suction power reduces.	The dust compartment is full and/or the filter is clogged.	Empty the dust compartment and clean the filter.
	The smart high torque brush bar and/or the extension rod are blocked.	Clear any blockages from the smart high torque brush bar and/or the extension rod.
The motor makes a strange noise.	The main suction opening or the extension rod is blocked.	Clear any blockages in the main suction opening or the extension rod.
The first indicator is red after turning on the vacuum cleaner.	Battery pack is damaged.	Please contact after-sales service to arrange maintenance.
The first indicator blinks red when charging the vacuum cleaner.	The charger is incompatible.	Only use the original charger to charge the vacuum cleaner.

Error	Possible Cause	Solution
The battery indicator does not light up while charging.	The charger is not connected to the vacuum cleaner.	Make sure the charger is plugged in correctly.
	The battery is fully charged and went into sleep mode.	The vacuum cleaner can be used normally.
	If the problem still persists after ruling out the above two possibilities, please contact after-sales service for help.	
The battery charges slowly.	The battery temperature is too low or too high.	Wait until the battery temperature normalizes, then resume use.
The water tank does not dispense water, or dispenses water slowly.	The water dispenser filter is clogged.	Clean or replace the water dispenser filter.
	The mop pad is dirty.	Clean or replace the mop pad.

Troubleshooting

If the vacuum cleaner is not working properly, the screen display will show an error message. Please refer to the troubleshooting table below to find your solution based on the error message.

Error Icon	Error Message	Solution
	Airway Blocked	Clear any blockages from the dust compartment, extension rod, and/or smart high torque brush bar.
	Low Battery	Recharge soon.
	Roller Brush Stuck	Refer to "Cleaning the smart high torque brush bar" under the Care & Maintenance section for directions on how to clean out hair and other debris caught in the roller brush.
	Battery Depleted	Recharge soon.
	Battery Overheated	Wait until the battery temperature normalizes before resuming use.
	Error	Please contact after-sales service to arrange maintenance.
	Filter Not Installed	Ensure that the HEPA filter and pre-filter are installed correctly.